

MWS Models

SPECIFICATIONS

MODEL	(1) EXCAVATOR WEIGHT APPROX 3rd Member		(2) ATTACHMENT WEIGHT APPROX		JAW OPENING		JAW DEPTH		(3) REACH	
	(lbs)	(m tons)	(lbs)	(kg)	(in)	(mm)	(in)	(mm)	(ft - in)	(m)
MWS 40	40,000 – 60,000	18 – 27	3,000	1,360	30 – 40	762 – 1,016	29	736	4' - 6"	1.4
MWS 80	70,000 – 95,000	32 – 43	5,100	2,313	50 – 60	1,270 – 1,524	41	1,041	6' - 0"	1.8

(1) Excavator weight recommendation is based on standard excavator weights and boom and/or arm lengths. All applications must be approved by LaBounty Manufacturing prior to sale.

(2) Attachment weight can vary depending upon mounting bracket, appropriate cylinder required to maximize base machine operating pressures, and any options installed on the shear.

(3) Reach can vary depending upon the bracket needed for the base machine.

NOTE: Weights, dimensions and operating specifications listed on this sheet are subject to change without notice. Where specifications are critical to your application, please consult LaBounty.

LaBounty MWS Mobile Wood Shears.

Ideal for applications involving the down-sizing of all wood materials including tree stumps, logs, railroad ties, wood demolition debris and other over-sized wood products. These attachments are ideal for wood waste recycling and land clearing operations.

Mobile Wood Shears Feature weld-in replaceable, hardened steel cutting blades that easily split large stumps and over-sized material into small pieces.

In addition, the LaBounty design features the maximum cutting force and maximum reach with minimum weight, reducing base machine movement and increasing operator safety.

No Additional Hydraulics Required. The MWS 40 and MWS 80 pin on in place of the excavator bucket, eliminating the need for additional hydraulics. A mounting pad is welded to the bottom of the excavator arm which then attaches to the position arm and the shear lower jaw. The same mounting pad can be used with HDR Grapples, BLS Bucket Linkage Shears and CP Concrete Pulverizers.

MWS Mobile Wood Shears Components

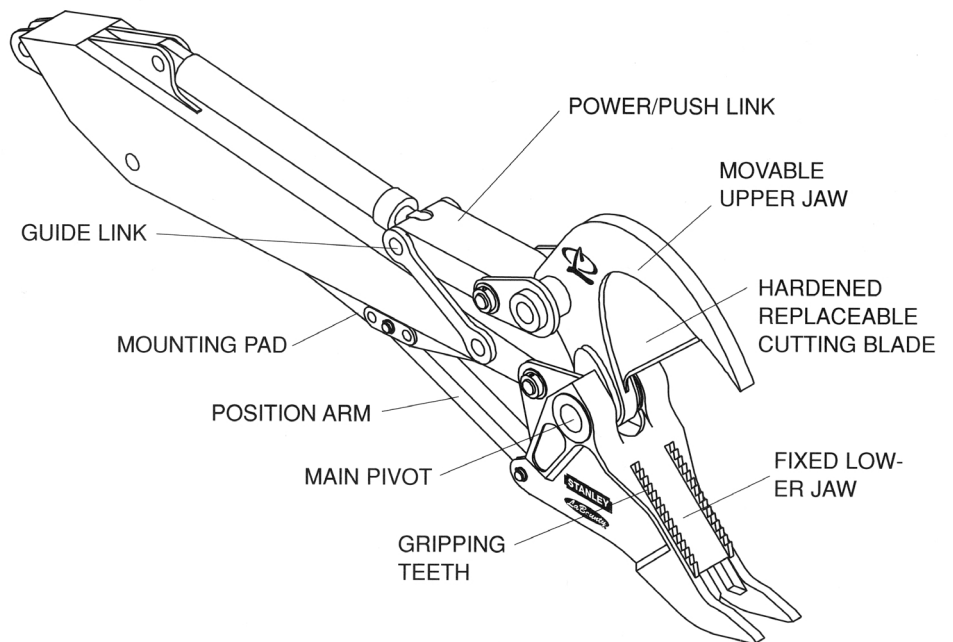

MWS MOBILE WOOD SHEAR OPTIONS, ACCESSORIES & WEAR PARTS

The items listed below are available for all MWS Mobile Wood Shears

- Weld-in Replaceable Cutting Blades
- At-factory Upgrade and Rebuilding Services

MWS Mobile Shear Operation

The LaBounty MWS 40 and MWS 80 Mobile Wood Shears replace the bucket of an excavator and operate with the same controls – no additional hydraulics are required. The bucket dump control operates the shear open and the bucket curl control operates the shear close.

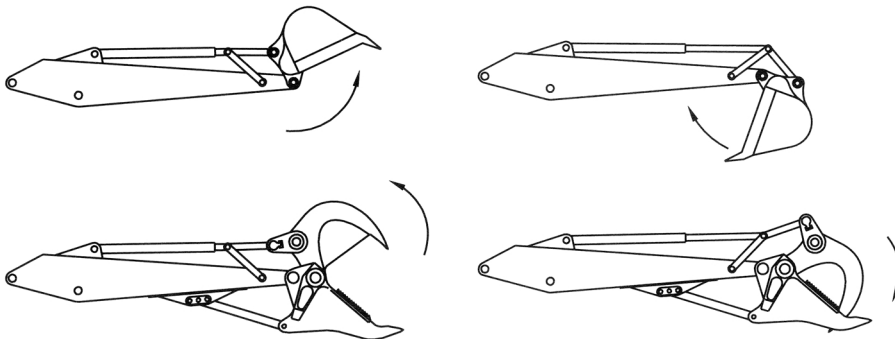

Bucket DUMP = Wood Shear OPEN

Bucket CURL = Wood Shear CLOSE

WARRANTY

LaBounty MWS Mobile Wood Shears carry a limited warranty against defects in material and workmanship for 12 months or 1,500 hours from the date of purchase.

LaBounty reserves the right to repair or replace only those parts which prove to have been defective at the time of purchase.

Ask your dealer to explain this warranty in detail.

Required MWS 40 and MWS 80 Mounting Pad Installation

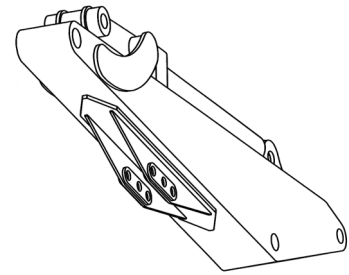

NOTE: Some excavator manufacturers may require stick reinforcement prior to mounting pad installation. Please consult with the original equipment manufacturer for details.

SAFETY FIRST! Please read, observe and follow the safety precautions found in the LaBounty Operations, Safety and Maintenance Manual shipped with your attachment.

Stanley Hydraulic Tools
LaBounty
1538 Highway 2
Two Harbors, MN 55616 USA
Tel: 218-834-2123 or 1-800-522-5059 Fax: 218-834-3879

STANLEY

LaBounty